

14 SERIES

- Ideal for jumper wire repairs on PC boards
- Insulated
- Slight protrusion eases insertion into mounting hole end
- Material: soft PVC coating (E58538(S))

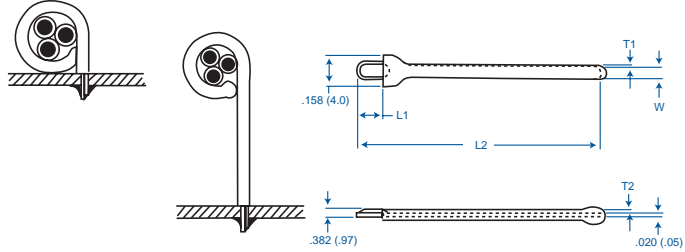

ITEM NO. 03-14-Series	
COLOR:	Black
PACKAGING:	500/bag
MATERIAL:	.5t Tin Plated Steel (clip) Soft PVC (coating)

ITEM NO.	L ₁ inches (mm)	L ₂ inches (mm)	W inches (mm)	T ₁ inches (mm)	T ₂ inches (mm)	Mounting Hole inches (mm)
03-14-10	.138 (3.5)	1.97 (50.0)	.079 (2.0)	>.008 (.2)	.023 (.6)	.039 x .106 (1.0 x 2.7)
03-14-20	.138 (3.5)	1.18 (30.0)	.079 (2.0)	>.008 (.2)	.023 (.6)	.039 x .106 (1.0 x 2.7)
Tolerance ±	.059 (1.5)				.012 (.3)	

16 SERIES

- Affix with screw to base
- Insulated
- Accomodates a wide range of bundle diameters
- Material: soft PVC coating (E58538(S))

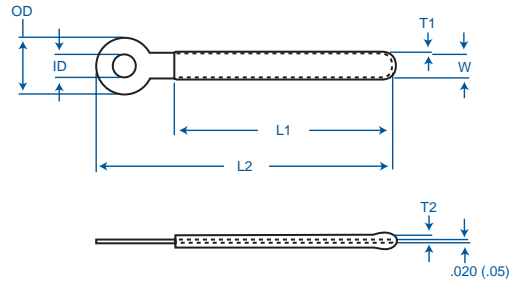
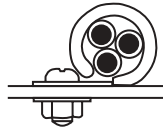

ITEM NO. 03-16-Series	
COLOR:	Black
PACKAGING:	500/bag
MATERIAL:	.5t Zinc Plated Steel (clip) Soft PVC (coating)

ITEM NO.	ID inches (mm)	OD inches (mm)	L ₁ inches (mm)	L ₂ inches (mm)	W inches (mm)	T ₁ inches (mm)	T ₂ inches (mm)
03-16-10	.130 (3.3)	.236 (6.0)	1.77 (45.0)	2.13 (54.0)	.138 (3.5)	>.008 (.2)	.039 (1.0)
03-16-20			1.18 (30.0)	1.61 (41.0)			
03-16-30			1.77 (45.0)	2.20 (56.0)			
03-16-40			2.17 (55.0)	2.60 (66.0)			
03-16-50	.173 (4.4)	.315 (8.0)	1.77 (45.0)	2.20 (56.0)	.177 (4.5)	>.008 (.2)	.039 (1.0)
03-16-60			2.17 (55.0)	2.60 (66.0)			
03-16-70			2.56 (65.0)	2.99 (76.0)			
03-16-80	.130 (3.3)	.315 (8.0)	1.93 (49.0)	2.36 (60.0)	.118 (3.0)	>.008 (.2)	.039 (1.0)
03-16-90	.138 (3.5)		.886 (22.5)	1.36 (34.5)			
Tolerance ±							.020 (.5)