

07 SERIES

- Mating rivets (need 2 pieces per assembly)
- Holds flat panels in assortment of materials
- Serrated teeth allow adjustments for a variety of panel thicknesses
- Material: U94V-2 (E39806(M))

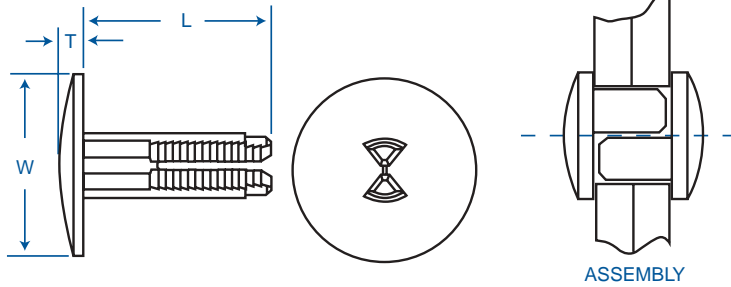

ITEM NO. 06-07-Series	
COLOR:	Natural
PACKAGING:	1000/bag (500 sets/bag)
MATERIAL:	Nylon 6

ITEM NO.	Hole Diam. inches (mm)	L		W		T		Assembled Panel Thickness Range	
		inches	(mm)	inches	(mm)	inches	(mm)	inches	(mm)
06-07-110	.281 (7.14)	.226	(5.74)	.406	(10.31)	.062	(1.57)	.235-.297	(5.97-7.54)
06-07-120		.344	(8.74)					.346-.500	(8.79-12.7)
06-07-130		.488	(12.40)					.500-.812	(12.7-20.6)
06-07-140		.768	(19.51)					.780-1.38	(19.8-35.1)
06-07-210	.281 (7.14)	.226	(5.74)	.750	(19.1)	.093	(2.36)	.235-.297	(5.97-7.54)
06-07-220		.334	(8.74)					.346-.500	(8.79-12.7)
06-07-230		.488	(12.40)					.500-.812	(12.7-20.6)
06-07-240		.768	(19.51)					.780-1.38	(19.8-35.1)

08 SERIES

- Barbed rivets
- Ribs provide secure lock
- Material: UL94V-2 (E39806(M))

	ITEM NO.	
	06-08-...N Series	06-08-...BK Series
COLOR:	Natural	Black
PACKAGING:	500/bag	500/bag
MATERIAL:	Nylon 66	Nylon 66

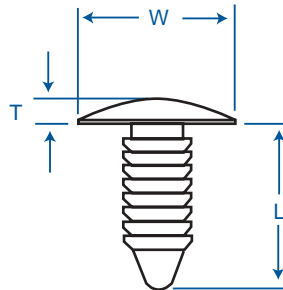

FIGURE 1

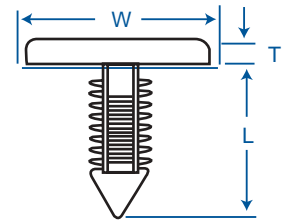

FIGURE 2



ITEM NO.	Hole Diam. inches (mm)	Panel Thickness Range inches (mm)	W		T		L		Fig. No.
			inches	(mm)	inches	(mm)	inches	(mm)	
06-08-10-N 06-08-10-Bk	.250 (6.4)	.155-.530 (3.8-13.5)	.698	(17.8)	.105	(2.7)	.780	(18.9)	1
06-08-20-N 06-08-20-Bk	.280 (7.15)	.095-.501 (2.4-12.7)	.628	(15.9)	.108	(2.8)	.892	(22.6)	
06-08-30-N 06-08-30-Bk	.187 (4.8)	.024-.367 (.64-9.3)	.377	(9.5)	.071	(1.8)	.500	(12.7)	
06-08-40-N 06-08-40-Bk	.187 (4.8)	.029-.332 (.76-8.4)	.433	(11.0)	.069	(1.7)	.564	(14.3)	2