

**51 SERIES**  
**52 SERIES**  
**53 SERIES**  
**54 SERIES**

- Male/female threaded hex nylon spacers
- Mates with AEH hex nut (12-00-series)
- Material: UL94V-2 (E157012(M))  
 UL94V-0 (upon request)

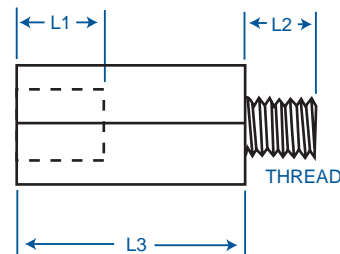
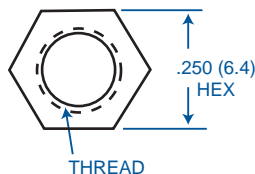

<b>ITEM NO.</b> 07-51-Series 07-52-Series 07-53-Series 07-54-Series
<b>COLOR:</b> Natural
<b>PACKAGING:</b> 500/bag
<b>MATERIAL:</b> Nylon 66

ITEM NO. #4-40 Thread	L <sub>1</sub> (Min.)		L <sub>2</sub>		L <sub>3</sub>	
	inches	(mm)	inches	(mm)	inches	(mm)
07-51-4250					.250	(6.4)
07-51-4312					.312	(7.9)
07-51-4375					.375	(9.5)
07-51-4438					.438	(11.11)
07-51-4500					.500	(12.7)
07-51-4562					.562	(14.29)
07-51-4625					.625	(15.9)
07-51-4688	.187	(4.8)	.187	(4.8)	.688	(17.5)
07-51-4750					.750	(19.1)
07-51-4813					.813	(20.6)
07-51-4875					.875	(22.2)
07-51-41000					1.00	(25.4)
07-51-41125					1.125	(28.6)
07-51-41250					1.250	(31.8)
07-51-41375					1.375	(34.9)

ITEM NO. #6-32 Thread	L <sub>1</sub> (Min.)		L <sub>2</sub>		L <sub>3</sub>	
	inches	(mm)	inches	(mm)	inches	(mm)
07-52-6250	.187	(4.8)			.250	(6.4)
07-52-6312					.312	(7.9)
07-52-6375					.375	(9.5)
07-52-6438					.438	(11.11)
07-52-6500					.500	(12.7)
07-52-6562					.562	(14.29)
07-52-6625					.625	(15.9)
07-52-6688	.250	(6.4)	.250	(6.4)	.688	(17.5)
07-52-6750					.750	(19.1)
07-52-6813					.813	(20.6)
07-52-6875					.875	(22.2)
07-52-61000					1.00	(25.4)
07-52-61125					1.125	(28.6)
07-52-61250					1.250	(31.8)
07-52-61375					1.375	(34.9)

ITEM NO. #8-32 Thread	L <sub>1</sub> (Min.)		L <sub>2</sub>		L <sub>3</sub>	
	inches	(mm)	inches	(mm)	inches	(mm)
07-53-8250	.187	(4.8)			.250	(6.4)
07-53-8312	.200	(5.1)			.312	(7.9)
07-53-8375					.375	(9.5)
07-53-8438					.438	(11.11)
07-53-8500					.500	(12.7)
07-53-8562					.562	(14.29)
07-53-8625					.625	(15.9)
07-53-8688					.688	(17.5)
07-53-8750	.375	(9.5)	.375	(9.5)	.750	(19.1)
07-53-8813					.813	(20.6)
07-53-8875					.875	(22.2)
07-53-81000					1.00	(25.4)
07-53-81125					1.125	(28.6)
07-53-81250					1.250	(31.8)
07-53-81375					1.375	(34.9)

ITEM NO. #10-32 Thread	L <sub>1</sub> (Min.)		L <sub>2</sub>		L <sub>3</sub>	
	inches	(mm)	inches	(mm)	inches	(mm)
07-54-10250	.187	(4.8)			.250	(6.4)
07-54-10312	.200	(5.1)			.312	(7.9)
07-54-10375					.375	(9.5)
07-54-10438					.438	(11.11)
07-54-10500					.500	(12.7)
07-54-10562					.562	(14.29)
07-54-10625					.625	(15.9)
07-54-10688					.688	(17.5)
07-54-10750	.375	(9.5)	.375	(9.5)	.750	(19.1)
07-54-10813					.813	(20.6)
07-54-10875					.875	(22.2)
07-54-101000					1.00	(25.4)
07-54-101125					1.125	(28.6)
07-54-101250					1.250	(31.8)
07-54-101375					1.375	(34.9)