

50 SERIES

- Insulating sleeves for flat type pin receptacles
- 205 series
- UL temperature rating: 105°
- CSA temperature rating: 105°
- UL voltage: 600V
- CSA voltage: 600V

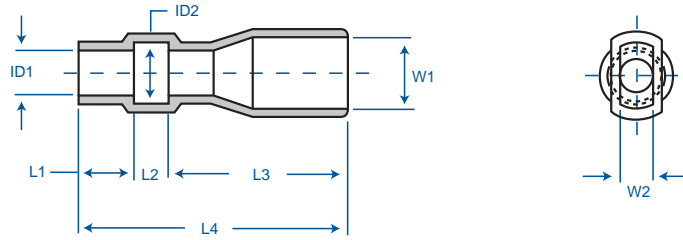

MATERIAL	PRODUCT
UL YELLOW	
CARD FILE #: E58538(S)	E55167(S)
CSA #: —	LR52853 & LR52854

ITEM NO. 10-50-Series	
COLOR:	Transparent Blue* <small>*Other colors available; inquiries welcome</small>
PACKAGING:	1000/bag
MATERIAL:	Soft PVC

ITEM NO.	ID1	ID2	L1	L2	L3	L4	W1	W2
	inches (mm)	inches (mm)	inches (mm)	inches (mm)	inches (mm)	inches (mm)	inches (mm)	inches (mm)
10-50-520	.079 (2.0)	.138 (3.5)	.197 (5.0)	.118 (3.0)	.630 (16.0)	.945 (24.0)	.256 (6.5)	.118 (3.0)
10-50-525	.098 (2.5)							
10-50-530	.118 (3.0)	.158 (4.0)	.197 (5.0)	.118 (3.0)	.630 (16.0)	.945 (24.0)	.256 (6.5)	.118 (3.0)
10-50-535	.138 (3.5)	.177 (4.5)						
10-50-540	.158 (4.0)	.197 (5.0)						
10-50-548	.189 (4.8)	.236 (6.0)						
Tolerance ±			.039 (1.0)		.039 (1.0)			

52 SERIES

- Insulating sleeves for flat type pin receptacles
- 250 series
- UL temperature rating: 105°
- CSA temperature rating: 105°
- UL voltage: 600V
- CSA voltage: 600V

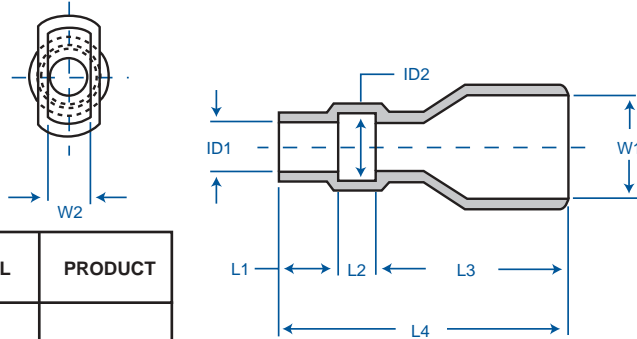

MATERIAL	PRODUCT
UL YELLOW	
CARD FILE #: E58538(S)	E55167(S)
CSA #: —	LR52853 & LR52854

ITEM NO. 10-52-Series	
COLOR:	Transparent Blue* <small>*Other colors available; inquiries welcome</small>
PACKAGING:	1000/bag
MATERIAL:	Soft PVC

ITEM NO.	ID1	ID2	L1	L2	L3	L4	W1	W2
	inches (mm)	inches (mm)	inches (mm)	inches (mm)	inches (mm)	inches (mm)	inches (mm)	inches (mm)
10-52-020	.079 (2.0)	.126 (3.2)	.197 (5.0)	.118 (3.0)	.630 (16.0)	.945 (24.0)	.315 (8.0)	.138 (3.5)
10-52-025	.098 (2.5)	.177 (4.5)		.138 (3.5)	.610 (15.5)			
10-52-030	.118 (3.0)			.098 (2.5)	.650 (16.5)			
10-52-032	.126 (3.2)	.185 (4.7)		.118 (3.0)	.630 (16.0)	.984 (25.0)		
10-52-035	.138 (3.5)	.177 (4.5)		.098 (2.5)	.689 (17.5)			
10-52-038	.150 (3.8)	.209 (5.3)		.118 (3.0)	.630 (16.0)	.965 (24.5)		
10-52-040	.158 (4.0)	.197 (5.0)		.098 (2.5)	.689 (17.5)	.984 (25.0)		
10-52-048	.189 (4.8)	.248 (6.3)		.098 (2.5)	.689 (17.5)	.984 (25.0)		
10-52-060	.236 (6.0)	.295 (7.5)			.768 (19.5)	1.06 (27.0)		
Tolerance ±				.039 (1.0)		.039 (1.0)		